

Palladium



technical data

Work area

Max. chuck diameter	mm	∅ 250
Swing diameter with automation	mm	∅ 200
Max. swing diameter with manual loading	mm	∅ 300
Travel X / Z	mm	220 / 280

2 Main spindles

Spindle flange according to DIN 55 026		A6
Spindle bearing, front	mm	∅ 140
Rotational speed		
- with transmission ratio 1:3 of intermediate gearbox	U/min	0-3000
- with transmission ratio 1:2 of intermediate gearbox	U/min	0-4500
Motor spindle – optional	U/min	0-6000

2 Main drives

AC asynchronous motor 25% / 100% duty cycle	kW	17,5 / 12,5
Maximum power consumption	kW	17,5
Full output w/ spindle speed	U/min	667
Torque 25% / 100% duty cycle	Nm	200 / 102

Feed drives

Rapid feed X, Z, U	m/min	30, 30
Feed force in X, Z	kN	5
Ball screw spindles in X, Z and U	mm	∅ 32, 40

Disc turret

Cylinder housing DIN 69 880		2 x 8x
Shank diameter		VDI 30

Electrical equipment

Operating voltage	V	400
Control voltage	V	24
	DC	
	AC	230
	Frequency	Hz
		50
Connected load	kW	40
In-line fuse	A	80
Type of electrical equipment		VDE 0113

Dimensions and weights

Width / with chip conveyor	mm	approx. 3200 / 4500
Depth / with terminal	mm	approx. 1800 / 2500
Height	mm	approx. 2800
Weight	kg	approx. 7000

palladium

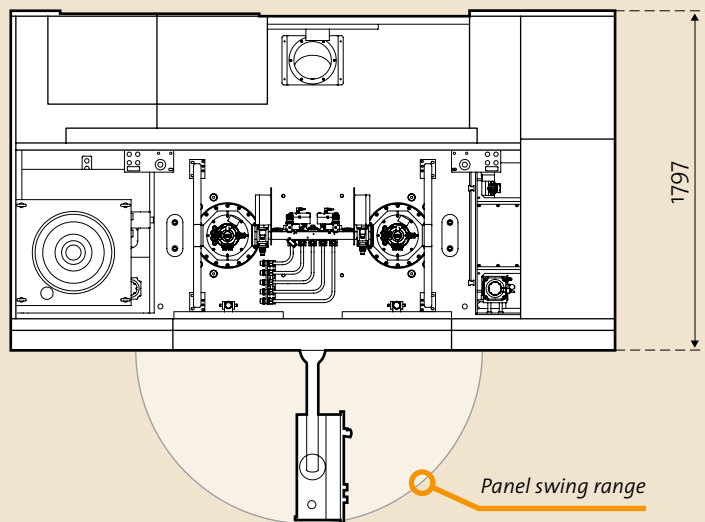
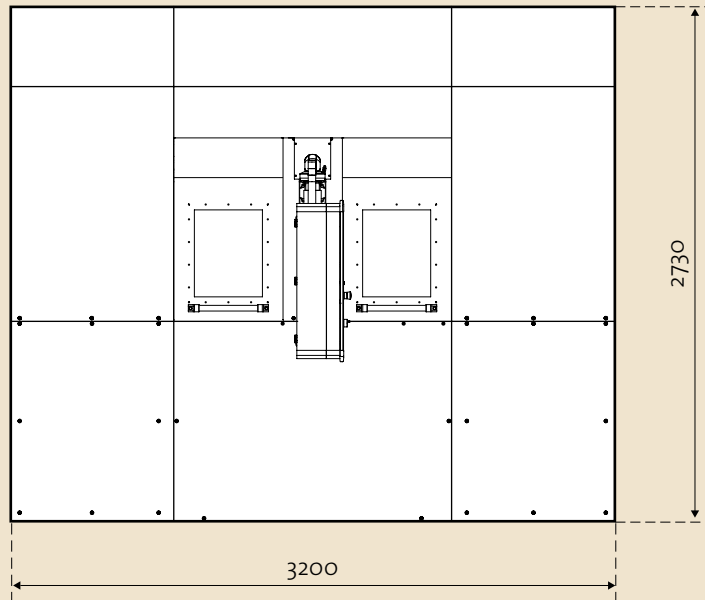

INVENTHOR

*By machinists
for machinists.*

Inventhor GmbH
Am Räsberg 2 · 29456 Hitzacker · Germany

Telephone +49 (0)5862/ 9418-59 · Fax -58
info@inventhor.de · www.inventhor.de